



2019 List Pricer
Effective from January 1st, 2019

Devon  Furniture
OFFICE

Terms & Conditions

Terms and conditions apply to all Devon Office Furniture (DOF) product lines unless otherwise noted.

Terms

- All new accounts must submit completed customer profile form prior to initial order.
- 50% deposit is required on all orders over \$5,000.
- Credit applications are available upon request.
- Accounts with delinquent invoices will be charged 1.5% per month.
- Visa, Mastercard, American Express and Discover are accepted. A convenience fee will be applied to all credit card payments. Contact customer service for a credit card form and fee schedule.

Ordering Procedures

- All orders must meet the following requirements:
- Received in writing via email or fax (610-537-6041).
- Include Purchase Order number and contact person.
- Specify fax number or email for order confirmations.
- Include model numbers and pricing.
- Include freight terms.

Order Confirmations

An order confirmation will be automatically faxed or emailed within 24 hours of your PO being entered. It is the customer's responsibility to verify the order for accuracy. **Orders will not go into production until an approval is received on the order.** DOF is not responsible for errors and omissions when assisting customers with quotes.

Lead Times

- Workstations Quick Ship – orders will ship within 7 - 10 business days after purchase order has been approved by customer.
- Workstations Non-Stock – orders will ship within 15 - 20 business days after purchase order has been approved by customer.
- Refer to the List Price documents for items which may require extended lead time.
- Lead time is based on date of submitted & approved Purchase Order – see Ordering Procedures above.

Rush Orders

Requests for rush orders will be accommodated if feasible, and will be subject to a 10% fee.

Shipping Policies & Fees

- All pricing is FOB Devon's distribution centers, unless otherwise noted.
- Standard shipping service includes loading dock delivery. It is the customer's responsibility to provide labor to unload product. Delivery is to dealer's location only. Delivery to end user's location will be accommodated if feasible for an additional fee.
- Contact customer service for local in-stock delivery programs.
- Most workstation orders are palletized and/or shrink wrapped. Each order will include packing lists and should be verified against the product on the pallets.

Claims

Claims for damages, shortages, or missing product must be made within 24 hours of receipt. Claims must be in writing and include the following:

- Signed packing list identifying the product.
- If order includes multiple pallets, claim must reference the pallet number listed on the packing list.
- Digital photographs of damaged packaging and product must be included with all damage claims.

Customer Requested Storage

DOF will store product for up to 3 days after scheduled ship date or pick-up date.

- Workstations Storage Fee – \$25 per pallet per day.

Workstations Return Policy

- Customer is responsible for all freight charges.
- No refunds will be made after 10 days from shipping date.
- Panels cannot be returned.
- Refunds for parts will be made after inspection of merchandise.
- Restocking Fee – 25% of net with a \$25 minimum.

Order Cancellations

Orders that are canceled prior to shipping are subject to the following fees:

- Workstations – 25% of net order (panels may not be canceled and are subject to full payment)

Warranty

Devon Office Furniture (DOF) offers a five (5) year limited warranty, unless otherwise noted, to the initial customer who purchases directly from Devon Office Furniture. DOF warrants that its products are free from defects in material and workmanship under normal use and with proper care and maintenance.

Panel Fabrics – All grades are covered by a three (3) year warranty period.

Customer's remedy under this limited warranty is limited to replacement. This limited warranty shall not apply to any product that suffered damage as the result of normal wear and tear, negligence, abuse, accident, or shipping damage.

This limited warranty does not cover the cost of transportation or labor. All requests for replacement under this limited warranty must be submitted in writing and provide reference to the original invoice number and freight bill, providing proof of delivery for the product for which Customer is claiming warranty replacement. Product will not be accepted by Devon Office Furniture for warranty replacement without the expressed, written consent provided by Devon Office Furniture prior to shipment. All freight charges on product must be prepaid, as Devon Office Furniture will not accept freight collect shipments.

DOF does not warrant the matching of colors, grain, or texture, except to within commercially reasonable standards.

Devon Office Furniture makes no warranty that its product is suitable for any particular purpose other than usage for which they were designed and makes no other warranties, expressed or implied, other than those set forth within this limited warranty. In no event shall Devon Office Furniture be liable either in tort or in contract for any loss or direct, special, incidental, consequential, or exemplary damages.

No officer, employee, agent, or representative of Devon Office Furniture has the authority to assume greater liability or enlarge upon this limited warranty.

EXCEPT AS PROVIDED BY THE EXPRESSED TERMS OF THIS WARRANTY, DEVON OFFICE FURNITURE MAKES NO OTHER WARRANTIES, EITHER EXPRESSED OR IMPLIED, TO ANY MATTER WHATSOEVER, AND EXPRESSLY DISCLAIMS ANY WARRANTY OF MERCHANTABILITY OR FITNESS FOR A PARTICULAR PURPOSE OR USE.

Fabric Covered Panels

- Panels include aluminum top cap, 5" metal base with glides, raceway covers, panel shells, hanger frames, and wedge blocks.
- All trim is Medium Tone, unless specified as Light Gray or Black Umber
- Panels are available in three (3) fabric series - Keystone(Grade 1), Summit(Grade 2), and Aspen (Grade 3) Please reference fabric name when ordering. Fabric cards available on request
- Panels have limited availability in 85" H, Medium Tone only.
- Summit (Grade 2) Fabric Options include Burch's In Demand Collection and Guilford of Maine's Pursuit and Bailey Collections
- Aspen (Grade 3) Fabric Options include Burch's Indemand Plus, In Demand Pluse II and Prime Collections, as well as Guilford of Maine's Dashing and Strata Collections.
- Fabric direction on Devon fabric cards shows direction with panel "railroaded" on fabric. Add 5% for vertical orientation.

FABRIC COVERED PANELS -- NON POWERED

Product Code	Product Description	Keystone/Gr. 1	Summit/Gr. 2	Aspen/Gr. 3
HM01.3924	39 X 24 FABRIC PANEL NON-POWERED PANEL	215.60	251.60	305.60
HM01.3930	39 X 30 FABRIC PANEL NON-POWERED PANEL	234.30	278.30	342.30
HM01.3936	39 X 36 FABRIC PANEL NON-POWERED PANEL	264.00	316.00	392.00
HM01.3942	39 X 42 FABRIC PANEL NON-POWERED PANEL	281.60	337.60	420.60
HM01.3948	39 X 48 FABRIC PANEL NON-POWERED PANEL	293.70	359.70	459.70
HM01.3960	39 X 60 FABRIC PANEL NON-POWERED PANEL	363.00	445.00	568.00
HM01.4724	47 X 24 FABRIC PANEL NON-POWERED PANEL	227.70	263.70	317.70
HM01.4730	47 X 30 FABRIC PANEL NON-POWERED PANEL	251.90	295.90	359.90
HM01.4736	47 X 36 FABRIC PANEL NON-POWERED PANEL	290.40	342.40	418.40
HM01.4742	47 X 42 FABRIC PANEL NON-POWERED PANEL	323.40	379.40	462.40
HM01.4748	47 X 48 FABRIC PANEL NON-POWERED PANEL	335.50	401.50	501.50
HM01.4760	47 X 60 FABRIC PANEL NON-POWERED PANEL	408.10	490.10	613.10
HM01.5324	53 X 24 FABRIC PANEL NON-POWERED PANEL	234.30	270.30	324.30
HM01.5330	53 X 30 FABRIC PANEL NON-POWERED PANEL	264.00	308.00	372.00
HM01.5336	53 X 36 FABRIC PANEL NON-POWERED PANEL	305.80	357.80	433.80
HM01.5342	53 X 42 FABRIC PANEL NON-POWERED PANEL	335.50	391.50	474.50
HM01.5348	53 X 48 FABRIC PANEL NON-POWERED PANEL	354.20	420.80	520.20
HM01.5360	53 X 60 FABRIC PANEL NON-POWERED PANEL	437.80	519.80	642.80
HM01.6724	67 X 24 FABRIC PANEL NON-POWERED PANEL	269.50	305.50	359.50
HM01.6730	67 X 30 FABRIC PANEL NON-POWERED PANEL	300.30	344.30	408.30
HM01.6736	67 X 36 FABRIC PANEL NON-POWERED PANEL	347.60	399.60	475.60
HM01.6742	67 X 42 FABRIC PANEL NON-POWERED PANEL	371.80	427.80	510.80
HM01.6748	67 X 48 FABRIC PANEL NON-POWERED PANEL	397.10	463.10	563.10
HM01.6760	67 X 60 FABRIC PANEL NON-POWERED PANEL	491.70	573.70	696.70

- Panels include aluminum top cap, 5" metal base with glides, raceway covers, panel shells, hanger frames, and wedge blocks.
- All trim is Medium Tone, unless specified as Light Gray or Black Umber
- Panels are available in three (3) fabric series - Keystone(Grade 1), Summit(Grade 2), and Aspen (Grade 3) Please reference fabric name when ordering. Fabric cards available on request
- Panels have limited availability in 85" H, Medium Tone only.
- Summit (Grade 2) Fabric Options include Burch's In Demand Collection and Guilford of Maine's Pursuit and Bailey Collections
- Aspen (Grade 3) Fabric Options include Burch's Indemand Plus, In Demand Pluse II and Prime Collections, as well as Guilford of Maine's Dashing and Strata Collections.
- Fabric direction on Devon fabric cards shows direction with panel "railroaded" on fabric. Add 5% for vertical orientation.

FABRIC COVERED PANELS -- POWERED

Product Code	Product Description	Keystone/Gr. 1	Summit/Gr. 2	Aspen/Gr. 3
HM01.3924.P4	39 X 24 FABRIC PANEL - POWERED 4 CIRCUIT	380.00	416.00	470.00
HM01.3930.P4	39 X 30 FABRIC PANEL - POWERED 4 CIRCUIT	437.75	481.75	545.75
HM01.3936.P4	39 X 36 FABRIC PANEL - POWERED 4 CIRCUIT	486.30	538.30	614.30
HM01.3942.P4	39 X 42 FABRIC PANEL - POWERED 4 CIRCUIT	512.85	568.85	651.85
HM01.3948.P4	39 X 48 FABRIC PANEL - POWERED 4 CIRCUIT	533.60	599.60	699.60
HM01.3960.P4	39 X 60 FABRIC PANEL - POWERED 4 CIRCUIT	623.70	705.70	828.70
HM01.4724.P4	47 X 24 FABRIC PANEL - POWERED 4 CIRCUIT	392.70	428.70	482.70
HM01.4730.P4	47 X 30 FABRIC PANEL - POWERED 4 CIRCUIT	457.40	501.40	565.40
HM01.4736.P4	47 X 36 FABRIC PANEL - POWERED 4 CIRCUIT	514.00	566.00	642.00
HM01.4742.P4	47 X 42 FABRIC PANEL - POWERED 4 CIRCUIT	556.70	612.70	695.70
HM01.4748.P4	47 X 48 FABRIC PANEL - POWERED 4 CIRCUIT	577.50	643.50	743.50
HM01.4760.P4	47 X 60 FABRIC PANEL - POWERED 4 CIRCUIT	669.90	751.90	874.90
HM01.5324.P4	53 X 24 FABRIC PANEL - POWERED 4 CIRCUIT	399.65	435.65	489.65
HM01.5330.P4	53 X 30 FABRIC PANEL - POWERED 4 CIRCUIT	470.10	514.10	578.10
HM01.5336.P4	53 X 36 FABRIC PANEL - POWERED 4 CIRCUIT	530.15	582.15	658.15
HM01.5342.P4	53 X 42 FABRIC PANEL - POWERED 4 CIRCUIT	569.45	625.45	705.45
HM01.5348.P4	53 X 48 FABRIC PANEL - POWERED 4 CIRCUIT	597.15	663.15	763.15
HM01.5360.P4	53 X 60 FABRIC PANEL - POWERED 4 CIRCUIT	701.10	783.10	906.10
HM01.6724.P4	67 X 24 FABRIC PANEL - POWERED 4 CIRCUIT	436.60	472.60	526.60
HM01.6730.P4	67 X 30 FABRIC PANEL - POWERED 4 CIRCUIT	507.05	551.05	615.05
HM01.6736.P4	67 X 36 FABRIC PANEL - POWERED 4 CIRCUIT	574.05	626.05	702.05
HM01.6742.P4	67 X 42 FABRIC PANEL - POWERED 4 CIRCUIT	606.40	662.40	745.40
HM01.6748.P4	67 X 48 FABRIC PANEL - POWERED 4 CIRCUIT	642.20	708.20	808.20
HM01.6760.P4	67 X 60 FABRIC PANEL - POWERED 4 CIRCUIT	757.70	839.70	962.70

Fabric Covered Panels *(cont'd)*

- Panels include aluminum top cap, 5" metal base with glides, raceway covers, panel shells, hanger frames, and wedge blocks.
- All trim is Medium Tone, unless specified as Light Gray or Black Umber
- Panels are available in three (3) fabric series - Keystone(Grade 1), Summit(Grade 2), and Aspen (Grade 3) Please reference fabric name when ordering. Fabric cards available on request
- Panels have limited availability in 85" H, Medium Tone only.
- Summit (Grade 2) Fabric Options include Burch's In Demand Collection and Guilford of Maine's Pursuit and Bailey Collections
- Aspen (Grade 3) Fabric Options include Burch's Indemand Plus, In Demand Pluse II and Prime Collections, as well as Guilford of Maine's Dashing and Strata Collections.
- Fabric direction on Devon fabric cards shows direction with panel "railroaded" on fabric. Add 5% for vertical orientation.

FABRIC COVERED PANELS W/ GLASS STACKER-- NON POWERED

Product Code	Product Description	Keystone /Gd.1	Summit/Gd 2	Aspen/Gd 3
HM51.5324	53 X 24 FABRIC PANEL NON-POWERED (39" Panel+14" glass stacker)	401.50	437.50	491.50
HM51.5330	53 X 30 FABRIC PANEL NON-POWERED (39" Panel+14" glass stacker)	462.00	506.00	570.00
HM51.5336	53 X 36 FABRIC PANEL NON-POWERED (39" Panel+14" glass stacker)	421.40	573.40	649.40
HM51.5342	53 X 42 FABRIC PANEL NON-POWERED (39" Panel+14" glass stacker)	581.90	637.90	720.90
HM51.5348	53 X 48 FABRIC PANEL NON-POWERED (39" Panel+14" glass stacker)	617.10	683.10	783.10
HM51.5360	53 X 60 FABRIC PANEL NON-POWERED (39" Panel+14" glass stacker)	719.40	801.40	924.40
HM51.6724	67 X 24 FABRIC PANEL NON-POWERED (53" Panel+14" glass stacker)	443.30	479.30	533.30
HM51.6730	67 X 30 FABRIC PANEL NON-POWERED (53" Panel+14" glass stacker)	503.80	547.80	611.80
HM51.6736	67 X 36 FABRIC PANEL NON-POWERED (53" Panel+14" glass stacker)	563.20	615.20	691.20
HM51.6742	67 X 42 FABRIC PANEL NON-POWERED (53" Panel+14" glass stacker)	623.70	679.70	792.70
HM51.6748	67 X 48 FABRIC PANEL NON-POWERED (53" Panel+14" glass stacker)	677.60	743.60	843.60
HM51.6760	67 X 60 FABRIC PANEL NON-POWERED (53" Panel+14" glass stacker)	797.50	879.50	1002.50

FABRIC COVERED PANELS w/ GLASS STACKER - POWERED

Product Code	Product Description	Keystone/Gr. 1	Summit/Gr. 2	Aspen/Gr. 3
HM51.5324.P4	53 X 24 FABRIC PANEL POWERED (39" Panel+14" glass stacker)	575.20	611.20	665.20
HM51.5330.P4	53 X 30 FABRIC PANEL POWERED (39" Panel+14" glass stacker)	676.85	720.85	784.85
HM51.5336.P4	53 X 36 FABRIC PANEL POWERED (39" Panel+14" glass stacker)	756.55	808.55	884.55
HM51.5342.P4	53 X 42 FABRIC PANEL POWERED (39" Panel+14" glass stacker)	827.00	883.00	966.00
HM51.5348.P4	53 X 48 FABRIC PANEL POWERED (39" Panel+14" glass stacker)	873.20	939.20	1039.20
HM51.5360.P4	53 X 60 FABRIC PANEL POWERED (39" Panel+14" glass stacker)	996.80	1078.80	1201.80
HM51.6724.P4	67 X 24 FABRIC PANEL POWERED (53" Panel+14" glass stacker)	619.10	655.10	709.10
HM51.6730.P4	67 X 30 FABRIC PANEL POWERED (53" Panel+14" glass stacker)	721.90	765.90	829.90
HM51.6736.P4	67 X 36 FABRIC PANEL POWERED (53" Panel+14" glass stacker)	800.45	852.45	928.45
HM51.6742.P4	67 X 42 FABRIC PANEL POWERED (53" Panel+14" glass stacker)	870.90	926.90	1009.90
HM51.6748.P4	67 X 48 FABRIC PANEL POWERED (53" Panel+14" glass stacker)	940.00	1006.00	1106.00
HM51.6760.P4	67 X 60 FABRIC PANEL POWERED (53" Panel+14" glass stacker)	1078.80	1160.80	1283.80

- Panels include aluminum top cap, 5" metal base with glides, raceway covers, panel shells, hanger frames, and wedge blocks.
- All trim is Medium Tone, unless specified as Light Gray or Black Umber
- Panels are available in three (3) fabric series - Keystone(Grade 1), Summit(Grade 2), and Aspen (Grade 3) Please reference fabric name when ordering. Fabric cards available on request
- Panels have limited availability in 85" H, Medium Tone only.
- Summit (Grade 2) Fabric Options include Burch's In Demand Collection and Guilford of Maine's Pursuit and Bailey Collections
- Aspen (Grade 3) Fabric Options include Burch's Indemand Plus, In Demand Pluse II and Prime Collections, as well as Guilford of Maine's Dashing and Strata Collections.
- Fabric direction on Devon fabric cards shows direction with panel "railroaded" on fabric. Add 5% for vertical orientation.

FABRIC COVERED PANELS W/DOUBLE GLASS STACKER

Product Code	Product Description	Keystone/Gr. 1	Summit/Gr.2	Aspen/Gr. 3
HM52.6724	67 X 24 FABRIC PANEL NON-POWERED (39" Panel+ (2)14" glass stacker)	579.70	615.70	669.70
HM52.6730	67 X 30 FABRIC PANEL NON-POWERED (39" Panel+ (2)14" glass stacker)	660.00	704.00	768.00
HM52.6736	67 X 36 FABRIC PANEL NON-POWERED (39" Panel+ (2) 14" glass stacker)	735.90	787.90	863.90
HM52.6742	67 X 42 FABRIC PANEL NON-POWERED (39" Panel+ (2) 14" glass stacker)	832.70	888.70	971.70
HM52.6748	67 X 48 FABRIC PANEL NON-POWERED (39" Panel+ (2) 14" glass stacker)	902.00	968.00	1068.00
HM52.6760	67 X 60 FABRIC PANEL NON-POWERED (39" Panel+ (2) 14" glass stacker)	1069.20	1151.20	1274.20
HM52.6724.P4	67 X 24 FABRIC PANEL POWERED (39" Panel+ (2) 14" glass stacker)	755.50	791.50	845.50
HM52.6730.P4	67 X 30 FABRIC PANEL POWERED (39" Panel+ (2) 14" glass stacker)	878.50	922.10	986.10
HM52.6736.P4	67 X 36 FABRIC PANEL POWERED (39" Panel+ (2) 14" glass stacker)	973.15	1025.15	1101.15
HM52.6742.P4	67 X 42 FABRIC PANEL POWERED (39" Panel+ (2) 14" glass stacker)	1079.90	1135.90	1218.90
HM52.6748.P4	67 X 48 FABRIC PANEL POWERED (39" Panel+ (2) 14" glass stacker)	1164.40	1230.40	1330.40
HM52.6760.P4	67 X 60 FABRIC PANEL POWERED (39" Panel+ (2) 14" glass stacker)	1350.50	1432.50	1555.50

GLASS STACKER - 14" KEYSTONE, SUMMIT, AND ASPEN

Product Code	Product Description	List Price
HMGFK1424	GLASS STACKER UPGRADE 24"	136.40
HMGFK1430	GLASS STACKER UPGRADE 30"	156.20
HMGFK1436	GLASS STACKER UPGRADE 36"	172.70
HMGFK1442	GLASS STACKER UPGRADE 42"	209.00
HMGFK1448	GLASS STACKER UPGRADE 48"	224.40
HMGFK1460	GLASS STACKER UPGRADE 60"	271.70

Fabric Covered Panels *(cont'd)*

- Panels include aluminum top cap, 5" metal base with glides, raceway covers, panel shells, hanger frames, and wedge blocks.
- All trim is Medium Tone, unless specified as Light Gray or Black Umber
- Panels are available in three (3) fabric series - Keystone(Grade 1), Summit(Grade 2), and Aspen (Grade 3) Please reference fabric name when ordering. Fabric cards available on request
- Panels have limited availability in 85" H, Medium Tone only.
- Summit (Grade 2) Fabric Options include Burch's In Demand Collection and Guilford of Maine's Pursuit and Bailey Collections
- Aspen (Grade 3) Fabric Options include Burch's Indemand Plus, In Demand Pluse II and Prime Collections, as well as Guilford of Maine's Dashing and Strata Collections.
- Fabric direction on Devon fabric cards shows direction with panel "railroaded" on fabric. Add 5% for vertical orientation.

FABRIC COVERED PANELS W/ FABRIC STACKER-- NON POWERED

Product Code	Product Description	Keystone/Gr.1	Summit/Gr.2	Aspen/Gr.3
HM61.5324	53 X 24 FABRIC PANEL NON-POWERED (39" Panel+14" fabric stacker)	401.50	437.50	491.50
HM61.5330	53 X 30 FABRIC PANEL NON-POWERED (39" Panel+14" fabric stacker)	462.00	506.00	570.00
HM61.5336	53 X 36 FABRIC PANEL NON-POWERED (39" Panel+14" fabric stacker)	521.40	573.40	649.40
HM61.5342	53 X 42 FABRIC PANEL NON-POWERED (39" Panel+14" fabric stacker)	581.90	637.90	720.90
HM61.5348	53 X 48 FABRIC PANEL NON-POWERED (39" Panel+14" fabric stacker)	617.10	683.10	783.10
HM61.5360	53 X 60 FABRIC PANEL NON-POWERED (39" Panel+14" fabric stacker)	719.40	801.40	924.40
HM61.6724	67 X 24 FABRIC PANEL NON-POWERED (53" Panel+14" fabric stacker)	443.30	479.30	533.30
HM61.6730	67 X 30 FABRIC PANEL NON-POWERED (53" Panel+14" fabric stacker)	503.80	547.80	611.80
HM61.6736	67 X 36 FABRIC PANEL NON-POWERED (53" Panel+14" fabric stacker)	563.20	615.20	691.20
HM61.6742	67 X 42 FABRIC PANEL NON-POWERED (53" Panel+14" fabric stacker)	623.70	679.70	762.70
HM61.6748	67 X 48 FABRIC PANEL NON-POWERED (53" Panel+14" fabric stacker)	677.60	743.60	843.60
HM61.6760	67 X 60 FABRIC PANEL NON-POWERED (53" Panel+14" fabric stacker)	797.50	879.50	1002.50

FABRIC COVERED PANELS w/ FABRIC STACKER - POWERED

Product Code	Product Description	Keystone/Gr. 1	Summit/Gr.2	Aspen/Gr.3
HM61.5324.P4	53 X 24 FABRIC PANEL POWERED (39" Panel+14" fabric stacker)	575.20	611.20	665.20
HM61.5330.P4	53 X 30 FABRIC PANEL POWERED (39" Panel+14" fabric stacker)	676.85	720.85	784.85
HM61.5336.P4	53 X 36 FABRIC PANEL POWERED (39" Panel+14" fabric stacker)	756.55	808.55	884.55
HM61.5342.P4	53 X 42 FABRIC PANEL POWERED (39" Panel+14" glass stacker)	827.00	883.00	966.00
HM61.5348.P4	53 X 48 FABRIC PANEL POWERED (39" Panel+14" fabric stacker)	873.20	939.20	1039.20
HM61.5360.P4	53 X 60 FABRIC PANEL POWERED (39" Panel+14" fabric stacker)	996.80	1078.80	1201.80
HM61.6724.P4	67 X 24 FABRIC PANEL POWERED (53" Panel+14" fabric stacker)	619.10	655.10	709.10
HM61.6730.P4	67 X 30 FABRIC PANEL POWERED (53" Panel+14" fabric stacker)	721.90	765.90	8029.90
HM61.6736.P4	67 X 36 FABRIC PANEL POWERED (53" Panel+14" fabric stacker)	800.45	852.45	928.45
HM61.6742.P4	67 X 42 FABRIC PANEL POWERED (53" Panel+14" fabric stacker)	870.90	926.90	1009.90
HM61.6748.P4	67 X 48 FABRIC PANEL POWERED (53" Panel+14" fabric stacker)	940.00	1006.00	1106.00
HM61.6760.P4	67 X 60 FABRIC PANEL POWERED (53" Panel+14" fabric stacker)	1078.80	1160.80	1283.80

- Panels include aluminum top cap, 5" metal base with glides, raceway covers, panel shells, hanger frames, and wedge blocks.
- All trim is Medium Tone, unless specified as Light Gray or Black Umber
- Panels are available in three (3) fabric series - Keystone(Grade 1), Summit(Grade 2), and Aspen (Grade 3) Please reference fabric name when ordering. Fabric cards available on request
- Panels have limited availability in 85" H, Medium Tone only.
- Summit (Grade 2) Fabric Options include Burch's In Demand Collection and Guilford of Maine's Pursuit and Bailey Collections
- Aspen (Grade 3) Fabric Options include Burch's Indemand Plus, In Demand Pluse II and Prime Collections, as well as Guilford of Maine's Dashing and Strata Collections.
- Fabric direction on Devon fabric cards shows direction with panel "railroaded" on fabric. Add 5% for vertical orientation.

FABRIC COVERED PANELS W/ FABRIC STACKER-- NON POWERED

Product Code	Product Description	Keystone/Gr. 1	Summit/Gr.2	Aspen/Gr. 3
HM62.6724	67 X 24 FABRIC PANEL NON-POWERED (39" Panel+ (2)14" glass stacker)	579.70	615.70	669.70
HM62.6730	67 X 30 FABRIC PANEL NON-POWERED (39" Panel+ (2)14" glass stacker)	660.00	704.00	768.00
HM62.6736	67 X 36 FABRIC PANEL NON-POWERED (39" Panel+ (2) 14" glass stacker)	735.90	787.90	863.90
HM62.6742	67 X 42 FABRIC PANEL NON-POWERED (39" Panel+ (2) 14" glass stacker)	832.70	888.70	971.70
HM62.6748	67 X 48 FABRIC PANEL NON-POWERED (39" Panel+ (2) 14" glass stacker)	902.00	968.00	1068.00
HM62.6760	67 X 60 FABRIC PANEL NON-POWERED (39" Panel+ (2) 14" glass stacker)	1069.20	1151.20	1274.20
HM62.6724.P4	67 X 24 FABRIC PANEL POWERED (39" Panel+ (2) 14" glass stacker)	755.50	791.50	845.50
HM62.6730.P4	67 X 30 FABRIC PANEL POWERED (39" Panel+ (2) 14" glass stacker)	878.10	922.10	986.10
HM62.6736.P4	67 X 36 FABRIC PANEL POWERED (39" Panel+ (2) 14" glass stacker)	973.15	1025.15	1101.15
HM62.6742.P4	67 X 42 FABRIC PANEL POWERED (39" Panel+ (2) 14" glass stacker)	1079.90	1135.90	1218.90
HM62.6748.P4	67 X 48 FABRIC PANEL POWERED (39" Panel+ (2) 14" glass stacker)	1164.40	1230.40	1330.40
HM62.6760.P4	67 X 60 FABRIC PANEL POWERED (39" Panel+ (2) 14" glass stacker)	1350.50	1432.50	1555.50

FABRIC STACKER 14"

Product Code	Product Description	Keystone/Gr. 1	Summit/Gr.2	Aspen/Gr. 3
HMFS1424	FABRIC STACKER UPGRADE 24"	136.40	172.40	226.40
HMFS1430	FABRIC STACKER UPGRADE 30"	156.20	200.20	264.20
HMFS1436	FABRIC STACKER UPGRADE 36"	172.70	224.70	300.70
HMFS1442	FABRIC STACKER UPGRADE 42"	209.00	265.00	348.00
HMFS1448	FABRIC STACKER UPGRADE 48"	224.40	290.40	390.40
HMFS1460	FABRIC STACKER UPGRADE 60"	271.70	353.70	476.70

Connectors

- Panel-to-panel connector ships with top and bottom block assembled.
- 2 and 3-way connectors ship assembled with 5" stem and raceway cover.
- Finished end ships with the raceway cover unassembled.
- Wall-start ships unassembled and can be used to connect panel to a structural wall.

Product Code	Product Description	List Price
HMP213.34	39" PANEL TO PANEL CONNECTOR	13.20
HMA224.34	39" CHANGE OF HEIGHT PANEL TO PANEL CONNECTOR KIT	19.80
HMA130.39	39" 2 WAY CONNECTOR	80.30
HMA137.39	39" 3 WAY CONNECTOR	92.40
HMC132.34	39" 4 WAY CONNECTOR	94.60
HMA128.39	39" FINISHED END KIT	36.30
HMA199.34	39" WALL START KIT	28.60
HMP213.42	47" PANEL TO PANEL CONNECTOR	13.20
HMA224.42	47" CHANGE OF HEIGHT PANEL TO PANEL CONNECTOR KIT	20.90
HMA130.47	47" 2 WAY CONNECTOR	88.00
HMA137.47	47" 3 WAY CONNECTOR	104.50
HMC132.42	47" 4 WAY CONNECTOR	107.80
HMA128.47	47" FINISHED END KIT	40.70
HMA199.42	47" WALL START KIT	34.10
HMP213.48	53" PANEL TO PANEL CONNECTOR	14.30
HMA224.48	53" CHANGE OF HEIGHT PANEL TO PANEL CONNECTOR KIT	25.30
HMA130.53	53" 2 WAY CONNECTOR	94.60
HMA137.53	53" 3 WAY CONNECTOR	116.60
HMC132.48	53" 4 WAY CONNECTOR	119.90
HMA128.53	53" FINISHED END KIT	42.90
HMA199.48	53" WALL START KIT	39.60
HMP213.62	67" PANEL TO PANEL CONNECTOR	14.30
HMA224.62	67" CHANGE OF HEIGHT PANEL TO PANEL CONNECTOR KIT	28.60
HMA130.67	67" 2 WAY CONNECTOR	103.40
HMA137.67	67" 3 WAY CONNECTOR	137.50
HMC132.62	67" 4 WAY CONNECTOR	160.60
HMA128.67	67" FINISHED END KIT	48.40
HMA199.62	67" WALL START KIT	41.80
HMHL3953	HI-LO FILLER STRIP FOR 39" to 53" (14")	20.90
HMHL3947	HI-LO FILLER STRIP FOR 39" to 47" (8")	20.90
HMHL3967	HI-LO FILLER STRIP FOR 39" to 67" (28")	20.90
HMHL4753	HI-LO FILLER STRIP FOR 47" to 53" (6")	20.90
HMHL4767	HI-LO FILLER STRIP FOR 47" to 67" (20")	20.90
HMHL5367	HI-LO FILLER STRIP FOR 53" to 67" (14")	20.90

Storage

- Binder bin kit ships unassembled and includes a shelf, full height shelf ends with half radius edge, and assembled locking flipper door unit.
- Half height shelf kit ships unassembled and includes a shelf with half height shelf ends with half radius edge.
- Full height shelf kit ships unassembled and includes a shelf with full height shelf ends with half radius edge.
- All storage products are MT finish, unless special order is requested.
- Pedestals and laterals include a 3/4 extension slide on box drawer and full extension slide on file drawer.
- Pedestals and laterals each include one (1) lock.

Product Code	Product Description	List Price
HMU271.24	24" BINDER BIN KIT W/ LOCK	213.40
HMU271.30	30" BINDER BIN KIT W/ LOCK	261.80
HMU271.36	36" BINDER BIN KIT W/ LOCK	269.50
HMU271.42	42" BINDER BIN KIT W/ LOCK	300.30
HMU271.48	48" BINDER BIN KIT W/ LOCK	322.30
HMU271.60	60" BINDER BIN KIT W/ LOCK	371.80
HMA281.24	24" HALF HEIGHT SHELF KIT	106.70
HMA281.30	30" HALF HEIGHT SHELF KIT	114.40
HMA281.36	36" HALF HEIGHT SHELF KIT	122.10
HMA281.42	42" HALF HEIGHT SHELF KIT	130.90
HMA281.48	48" HALF HEIGHT SHELF KIT	137.50
HMA281.60	60" HALF HEIGHT SHELF KIT	154.00
HMA282.24	24" FULL HEIGHT SHELF KIT	106.70
HMA282.30	30" FULL HEIGHT SHELF KIT	125.40
HMA282.36	36" FULL HEIGHT SHELF KIT	137.50
HMA282.42	42" FULL HEIGHT SHELF KIT	145.20
HMA282.48	48" FULL HEIGHT SHELF KIT	147.40
HMA282.60	60" FULL HEIGHT SHELF KIT	155.10
-->> Please specify hardware kit for pedestals and lateral in the Accessories section		
ECO-BBF-MT	ECO-Style BBF W/ LOCK	342.10
ECO-FF-MT	ECO-Style FF W/ LOCK	342.10
G-LF230	G-Style 30" 2 DR. LATERAL FILE W/ LOCK	671.00

Work Surfaces

- Work surfaces are fabricated from a 1" thick particle board and are laminated on both sides in a thermally fused melamine finish.
- Work surface edges are finished on all sides with a color matched 2mm PVC edge banding.
- All surfaces over 48" require additional center support
- Custom size work surfaces are available by request and may require extended lead times.

WORK SURFACES PROGRAM: MAPLE, PEPPERDUST, GRAY, CHERRY, WHITE, ESPRESSO, MAHOGANY

Product Code	Product Description	List Price
WS2424	24 X 24 STRAIGHT WORK SURFACE	105.60
WS2430	24 X 30 STRAIGHT WORK SURFACE	121.00
WS2436	24 X 36 STRAIGHT WORK SURFACE	141.90
WS2442	24 X 42 STRAIGHT WORK SURFACE	160.60
WS2448	24 X 48 STRAIGHT WORK SURFACE	165.00
WS2460	24 X 60 STRAIGHT WORK SURFACE	183.70
WS2466	24 X 66 STRAIGHT WORK SURFACE	242.00
WS2472	24 X 72 STRAIGHT WORK SURFACE	243.10
WS3048	30 X 48 STRAIGHT WORK SURFACE	247.50
WS3060	30 X 60 STRAIGHT WORK SURFACE	309.40
WS3066	30 X 66 STRAIGHT WORK SURFACE	341.00
WS3072	30 X 72 STRAIGHT WORK SURFACE	371.25
WSC2436	24 X 36 X 36 X 24 RADIUS CORNER WORK SURFACE	202.40
WSCR2442	24 X 42 X 42 X 24 RADIUS CORNER WORK SURFACE	260.70
WSCR2448	24 X 48 X 48 X 28 RADIUS CORNER WORK SURFACE	368.50
WSD3070	30 X 70 D-TOP w/ 3" BLACK METAL POST LEG	443.30
MIS-002	CUSTOM CUT UP-CHARGE (cut existing size)	80.30

Electric - 4 Circuit

- Electric system is an 8-wire 4-circuit system and is UL listed.
- Double blocks and pass-thrus are shipped loose and are to be field installed to clips. Clips ship pre-assembled to panels.

Product Code	Product Description	List Price
BE-24JU	24" PASS THRU	97.00
BE-30JU	30" PASS THRU	102.80
BE-36JU	36" PASS THRU	109.75
BE-42JU	42" PASS THRU	115.50
BE-48JU	48" PASS THRU	128.20
BE-60JU	60" PASS THRU	143.25
BE-REC1	RECEPTACLE - CIRCUIT 1	21.95
BE-REC2	RECEPTACLE - CIRCUIT 2	21.95
BE-REC3	RECEPTACLE - CIRCUIT 3	21.95
BE-REC4	RECEPTACLE - CIRCUIT 4 (dedicated)	21.95
BE-ENDFD	END FEED	209.05
BE-SDFD1	SIDE FEED	232.15
BE-CELF	CEILING FEED	268.00
BE-PP12	POWER POLE KIT 12'	227.55
BE-NYCFD	NYC FEED	266.80
HMP550.01	OUTLET COVER CLIP	4.40

Typical Cube Layouts

67" High, 6 Stations, 6'x6', Keystone Fabric
Specs Per Station: BBF, Half Height Shelf, 2 Receptacles

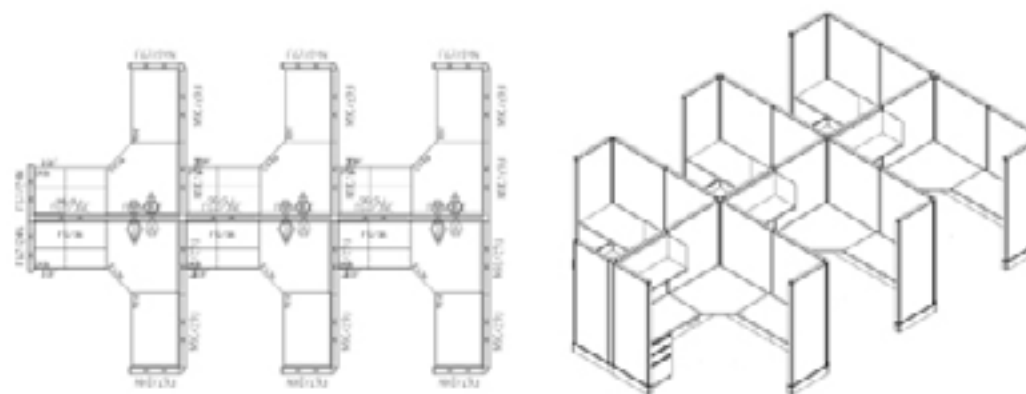

67" High, 6 Stations, 6'x6', Glass Stacker, Keystone Fabric
Specs Per Station: BBF, FF, Binder Bin, 2 Receptacles

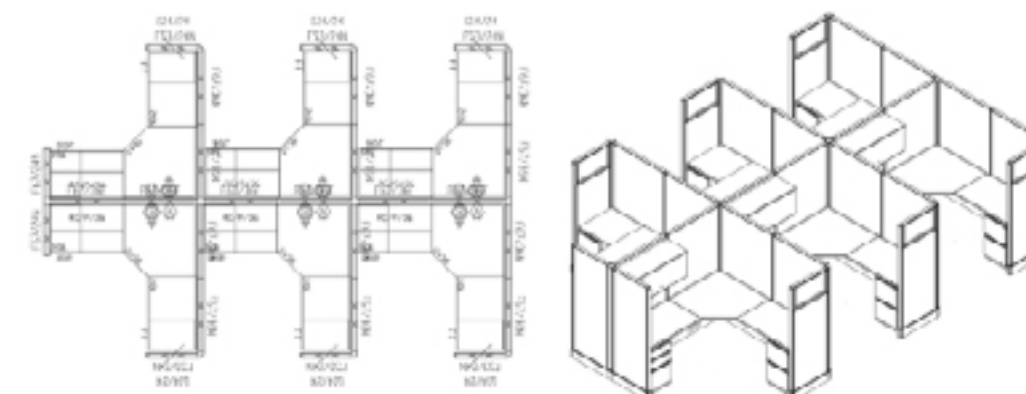

53" High, 6 Stations, 2'x4', Keystone Fabric
Specs Per Station: 1 Receptacle

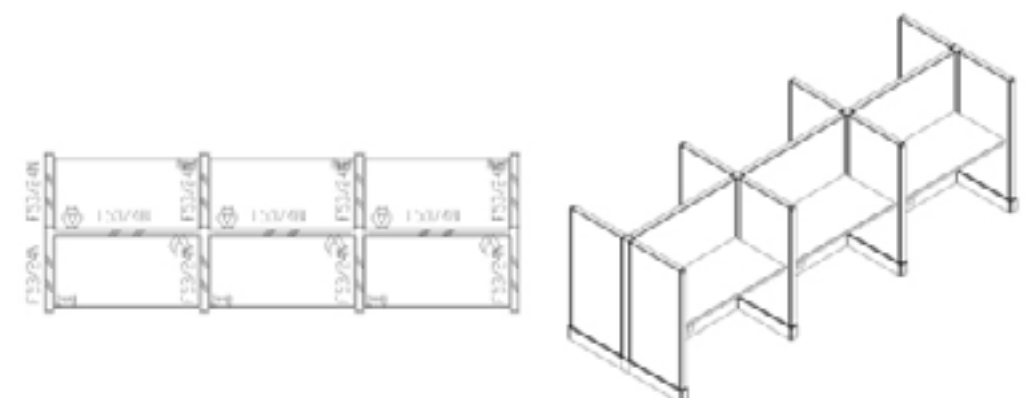

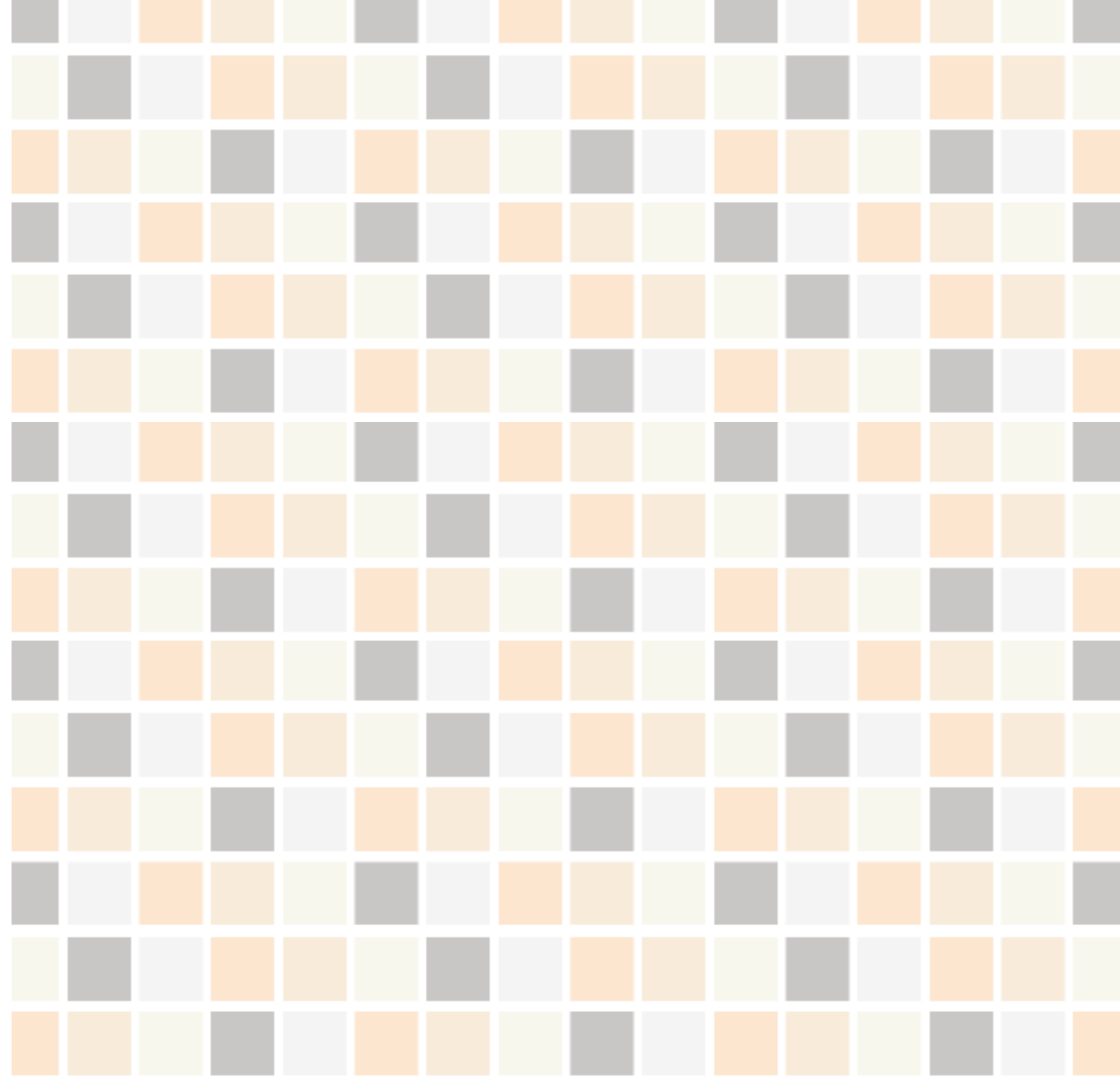
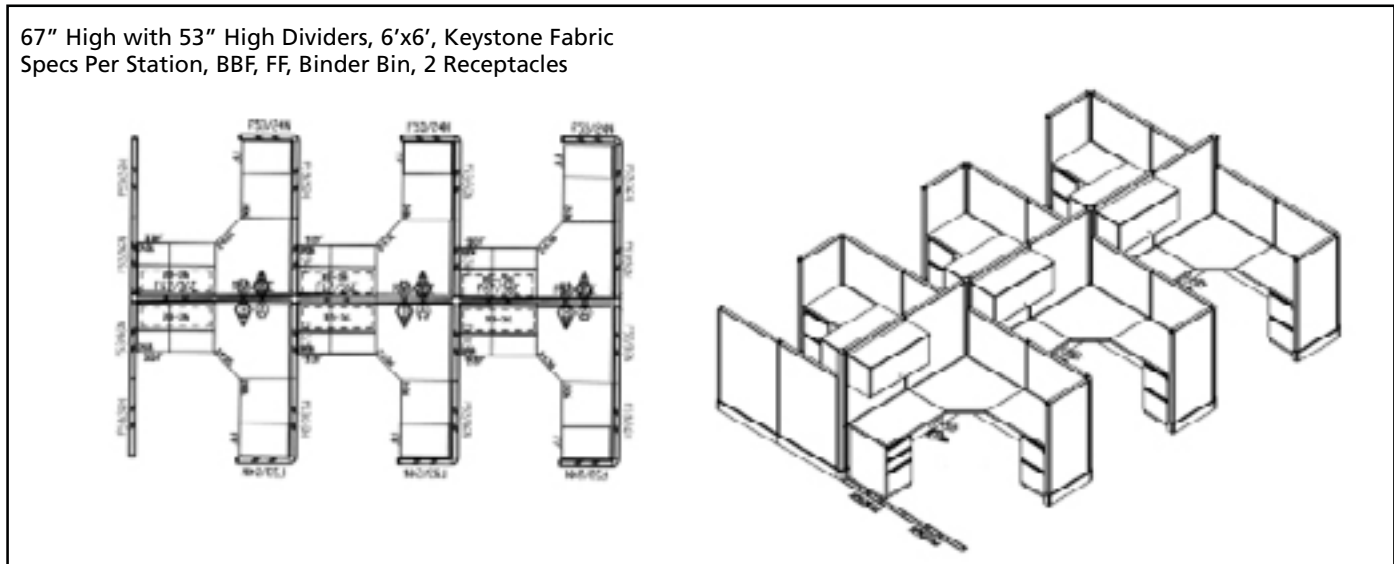
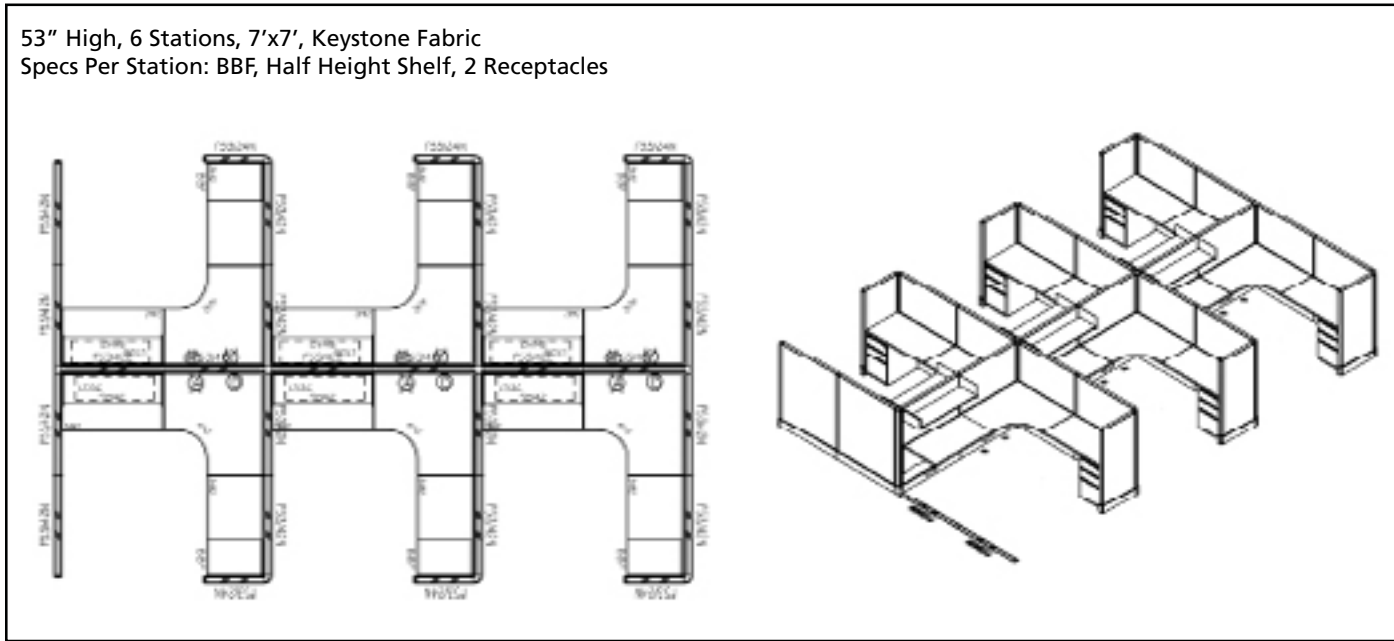

Headquarters:
700 American Ave., Suite 100
King of Prussia, PA 19406

National Distribution Center:
104 Zoar Road
Chesterfield, SC 29709

Sales & Customer Service:
P: 877-885-1608
F: 610-537-6041
E: sales@devonofficefurniture.com

