

Superior Quality

Attractive Designs

Reasonable Pricing



TERMS AND CONDITIONS

Terms and conditions apply to all Devon Office Furniture (DOF) product lines unless otherwise noted.

Terms

- All new accounts must submit completed customer profile form prior to initial order.
- 50% deposit is required on all orders over \$5,000.
- Credit applications are available upon request.
- Accounts with delinquent invoices will be charged 1.5% per month.
- American Express, Visa, and Mastercard are accepted. A convenience fee will be applied to all credit card payments. Contact customer service for a credit card form and fee schedule.

Ordering Procedures

All orders must meet the following requirements:

- Received in writing via email or fax (610-650-9960).
- Include Purchase Order number and contact person.
- Specify fax number or email for order confirmations.
- Include model numbers and pricing.
- Include freight terms.

Order Confirmations

An order confirmation will be automatically faxed or emailed within 24 hours of your PO being received. It is the customer's responsibility to verify the order for accuracy. DOF is not responsible for errors and omissions when assisting customers with quotes.

Lead Times

- Workstations Quick Ship – orders will ship within 5-10 business days after purchase order is received.
- Workstations Standard – orders will ship within 10-15 business days after purchase order is received.
- Casegoods Quick Ship – contact customer service for the in-stock Quick Ship program available in your area.
- Casegoods Standard – orders will ship within 10 business days after order is received.
- Refer to the List Price documents for items which may require extended lead time.
- Lead time is based on date of receipt of completed Purchase Order – see Ordering Procedures above.

Rush Orders

- Requests for rush orders will be accommodated if feasible, and will be subject to a 10% fee.

Shipping Policies & Fees

- All pricing is FOB Devon's distribution centers, unless otherwise noted.
- Standard shipping service includes loading dock delivery. It is the customer's responsibility to provide labor to unload product. Delivery is to dealer's location only. Delivery to end user's location will be accommodated if feasible for an additional fee.
- Contact customer service for local in-stock delivery programs.
- Most workstation orders are palletized and/or shrink wrapped. Each pallet will include its own packing list and should be verified against the product on the pallet.
- Casegoods products are shipped fully assembled in a specially designed packing system.
- All orders ship with a packing list which must be signed and dated by customer. All packing lists must be faxed back to Devon at 610-650-9960 within 24 hours of receipt.

Claims

Claims for damages, shortages, or missing product must be made within 24 hours of receipt. Claims must be in writing and include the following:

- Signed packing list identifying the product.
- If order includes multiple pallets, claim must reference the pallet number listed on the packing list.
- Digital photographs of damaged packaging and product must be included with all damage claims.

Customer Requested Storage

DOF will store product for up to 3 days after scheduled ship date or pick-up date.

- Workstations Storage Fee - \$25 per pallet per day.
- Casegoods Storage Fee - \$5 per box per day for non-stocked items.

Workstations Return Policy

- Customer is responsible for all freight charges.
- No refunds will be made after 10 days from shipping date.
- Panels cannot be returned.
- Refunds for parts will be made after inspection of merchandise.
- Restocking Fee – 25% of net with a \$25 minimum

Casegoods Return Policy

- Customer is responsible for all freight charges.
- No refunds will be made after 10 days from shipping date.
- No refunds will be made if product has been removed from original packaging or packaging has been altered.
- Restocking Fee – \$25 per piece/box

Order Cancellations

Orders that are cancelled prior to shipping are subject to the following fees:

- Workstations – 25% of net order (panels may not be cancelled and are subject to full payment)
- Casegoods - \$25 per piece/box

Limited Warranty

Devon Office Furniture (DOF) offers a five (5) year limited warranty, unless otherwise noted, to the initial customer who purchases directly from Devon Office Furniture. DOF warrants that its products are free from defects in material and workmanship under normal use and with proper care and maintenance.

Panel Fabrics - All grades are covered by a three (3) year warranty period.

Customer's remedy under this limited warranty is limited to replacement. This limited warranty shall not apply to any product that suffered damage as the result of normal wear and tear, negligence, abuse, accident, or shipping damage.

This limited warranty does not cover the cost of transportation or labor. All requests for replacement under this limited warranty must be submitted in writing and provide reference to the original invoice number and freight bill, providing proof of delivery for the product for which Customer is claiming warranty replacement. Product will not be accepted by Devon Office Furniture for warranty replacement without the expressed, written consent provided by Devon Office Furniture prior to shipment. All freight charges on product must be prepaid, as Devon Office Furniture will not accept freight collect shipments.

DOF does not warrant the matching of colors, grain, or texture, except to within commercially reasonable standards.

Devon Office Furniture makes no warranty that its product is suitable for any particular purpose other than usage for which they were designed and makes no other warranties, expressed or implied, other than those set forth within this limited warranty. In no event shall Devon Office Furniture be liable either in tort or in contract for any loss or direct, special, incidental, consequential, or exemplary damages.

No officer, employee, agent, or representative of Devon Office Furniture has the authority to assume greater liability or enlarge upon this limited warranty.

EXCEPT AS PROVIDED BY THE EXPRESSED TERMS OF THIS WARRANTY, DEVON OFFICE FURNITURE MAKES NO OTHER WARRANTIES, EITHER EXPRESSED OR IMPLIED, TO ANY MATTER WHATSOEVER, AND EXPRESSLY DISCLAIMS ANY WARRANTY OF MERCHANTABILITY OR FITNESS FOR A PARTICULAR PURPOSE OR USE.

Fabric Covered Panels

- Panels include aluminum top cap, 5" metal base with glides, raceway covers, panel shells, hanger frames, and wedge blocks.
- All trim is Medium Tone.
- Electric options are priced separately - refer to Electric section.
- Panels are available in three (3) fabric series - Keystone, Summit, and Aspen.
- Refer to the Devon fabric cards for fabric swatches.
- Fabric direction on Devon fabric cards shows direction with panel "railroaded" on fabric. Add 5% for vertical orientation.

KEYSTONE SERIES PANELS

- Quick Ship Fabric Options Include **Straw (7115)** and **Fog (7113)**.
- Standard Shipping Fabric Options Include **Taupe (7954)** and **Seagull (7961)**.

Product Code	Product Description	List Price
HM01.3924	39 X 24 Keystone Panel	180.00
HM01.3930	39 X 30 Keystone Panel	195.00
HM01.3936	39 X 36 Keystone Panel	220.00
HM01.3942	39 X 42 Keystone Panel	235.00
HM01.3948	39 X 48 Keystone Panel	245.00
HM01.3960	39 X 60 Keystone Panel	303.00
HM01.5324	53 X 24 Keystone Panel	195.00
HM01.5330	53 X 30 Keystone Panel	220.00
HM01.5336	53 X 36 Keystone Panel	255.00
HM01.5342	53 X 42 Keystone Panel	280.00
HM01.5348	53 X 48 Keystone Panel	295.00
HM01.5360	53 X 60 Keystone Panel	365.00
HM01.6724	67 X 24 Keystone Panel	225.00
HM01.6730	67 X 30 Keystone Panel	250.00
HM01.6736	67 X 36 Keystone Panel	290.00
HM01.6742	67 X 42 Keystone Panel	310.00
HM01.6748	67 X 48 Keystone Panel	331.00
HM01.6760	67 X 60 Keystone Panel	410.00

67" High, 6 Stations, 6'x6', Keystone Fabric
 Specs Per Station: BBF, Half Height Shelf, 2 Receptacles
 Worksurfaces: 24" x 36" Straight, 24" x 36" Corner

List Price: \$13,806
 Per Station: \$2,301

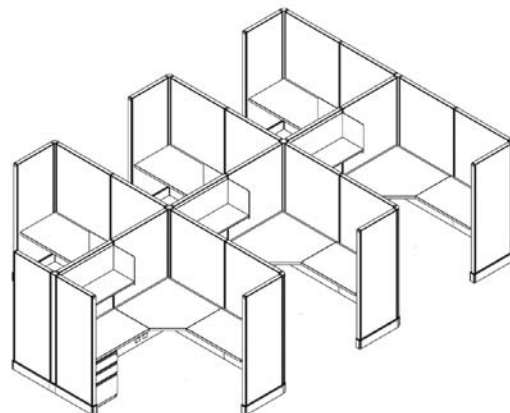
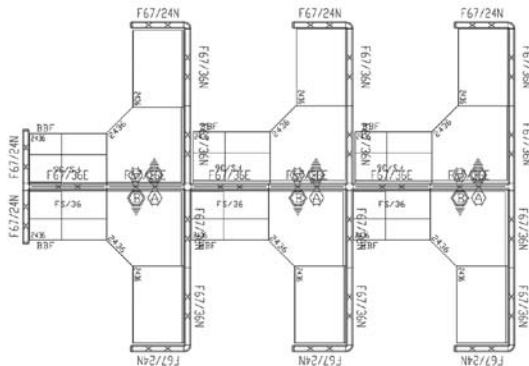

Fabric Covered Panels *(Continued)*

- Panels include aluminum top cap, 5" metal base with glides, raceway covers, panel shells, hanger frames, and wedge blocks.
- All trim is Medium Tone.
- Electric options are priced separately - refer to Electric section.
- Panels are available in three (3) fabric series - Keystone, Summit, and Aspen.
- Refer to the Devon fabric cards for fabric swatches.
- Fabric direction on Devon fabric cards shows direction with panel "railroaded" on fabric. Add 5% for vertical orientation.

SUMMIT SERIES PANELS

- Summit Fabric Options Include **Wheat (7239), Rye (7241), Chambray (7244), Steel (7425), Khaki (7919), and Stone (7923)**.
- Orders with Summit Series panels are not available for Quick Ship.

Product Code	Product Description	List Price
HM02.3924	39 X 24 Summit Panel	210.00
HM02.3930	39 X 30 Summit Panel	235.00
HM02.3936	39 X 36 Summit Panel	265.00
HM02.3942	39 X 42 Summit Panel	295.00
HM02.3948	39 X 48 Summit Panel	320.00
HM02.3960	39 X 60 Summit Panel	385.00
HM02.5324	53 X 24 Summit Panel	230.00
HM02.5330	53 X 30 Summit Panel	255.00
HM02.5336	53 X 36 Summit Panel	285.00
HM02.5342	53 X 42 Summit Panel	315.00
HM02.5348	53 X 48 Summit Panel	350.00
HM02.5360	53 X 60 Summit Panel	405.00
HM02.6724	67 X 24 Summit Panel	250.00
HM02.6730	67 X 30 Summit Panel	285.00
HM02.6736	67 X 36 Summit Panel	310.00
HM02.6742	67 X 42 Summit Panel	340.00
HM02.6748	67 X 48 Summit Panel	385.00
HM02.6760	67 X 60 Summit Panel	435.00

53" High, 6 Stations, 2'x4', Keystone Fabric
 Specs Per Station: 1 Receptacle
 Worksurfaces: 24" x 48" Straight

List Price: \$4,403
 Per Station: \$734

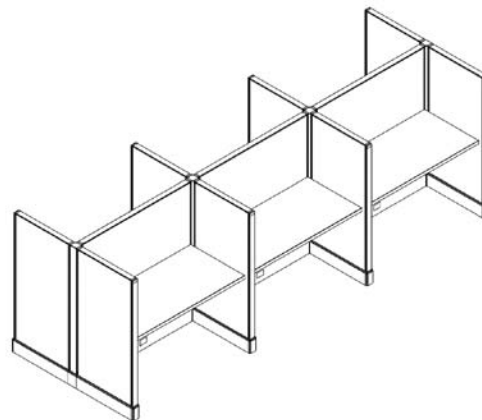
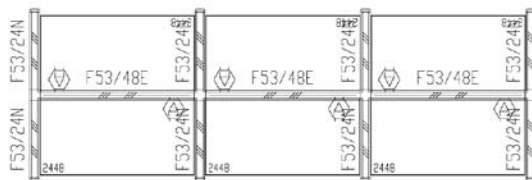

Fabric Covered Panels *(Continued)*

- Panels include aluminum top cap, 5" metal base with glides, raceway covers, panel shells, hanger frames, and wedge blocks.
- All trim is Medium Tone.
- Electric options are priced separately - refer to Electric section.
- Panels are available in three (3) fabric series - Keystone, Summit, and Aspen.
- Refer to the Devon fabric cards for fabric swatches.
- Fabric direction on Devon fabric cards shows direction with panel "railroaded" on fabric. Add 5% for vertical orientation.

ASPEN SERIES PANELS

- Refer to the Devon fabric card for fabric swatches. Please reference fabric name and number when ordering.
- Orders with Aspen Series panels are not available for Quick Ship.

Product Code	Product Description	List Price
HM03.3924	39 X 24 Aspen Panel	255.00
HM03.3930	39 X 30 Aspen Panel	285.00
HM03.3936	39 X 36 Aspen Panel	330.00
HM03.3942	39 X 42 Aspen Panel	365.00
HM03.3948	39 X 48 Aspen Panel	400.00
HM03.3960	39 X 60 Aspen Panel	465.00
HM03.5324	53 X 24 Aspen Panel	275.00
HM03.5330	53 X 30 Aspen Panel	310.00
HM03.5336	53 X 36 Aspen Panel	350.00
HM03.5342	53 X 42 Aspen Panel	380.00
HM03.5348	53 X 48 Aspen Panel	435.00
HM03.5360	53 X 60 Aspen Panel	500.00
HM03.6724	67 X 24 Aspen Panel	300.00
HM03.6730	67 X 30 Aspen Panel	335.00
HM03.6736	67 X 36 Aspen Panel	375.00
HM03.6742	67 X 42 Aspen Panel	415.00
HM03.6748	67 X 48 Aspen Panel	460.00
HM03.6760	67 X 60 Aspen Panel	530.00

67" High, 6 Stations, 6'x6', Glass Stacker, Keystone Fabric
 Specs Per Station: BBF, FF, Binder Bin, 2 Receptacles
 Worksurfaces: 24" x 36" Straight, 24" x 36" Corner

List Price: \$17,125
 Per Station: \$2,854

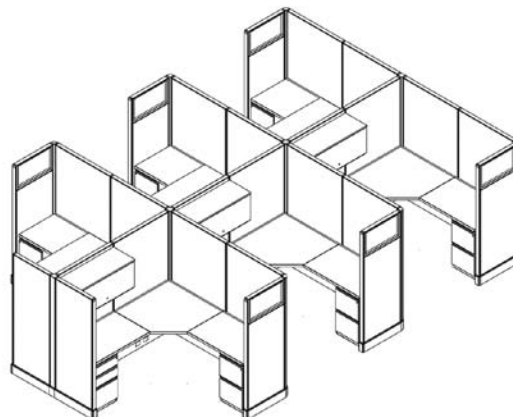
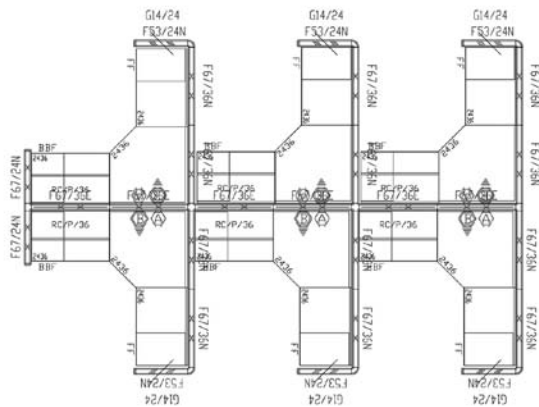

Typicals

67" High, 6 Stations, 6'x6', Keystone Fabric
 Specs Per Station: BBF, Half Height Shelf, 2 Receptacles
 Worksurfaces: 24/36" x 72" Extended Corner, 24" x 36" Straight, 30" x 70" D-Top

List Price: \$19,600
 Per Station: \$2,450

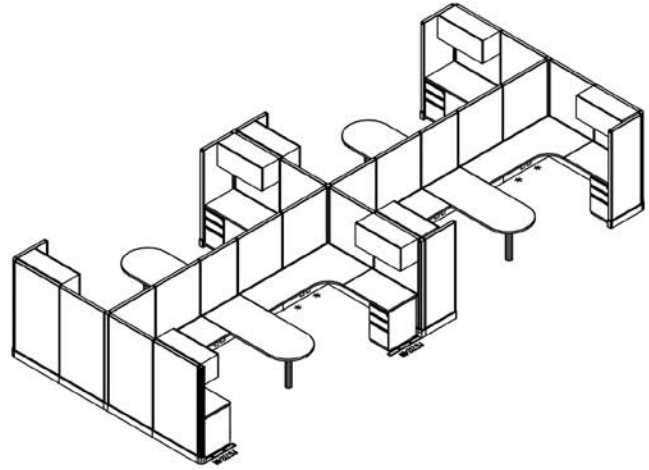
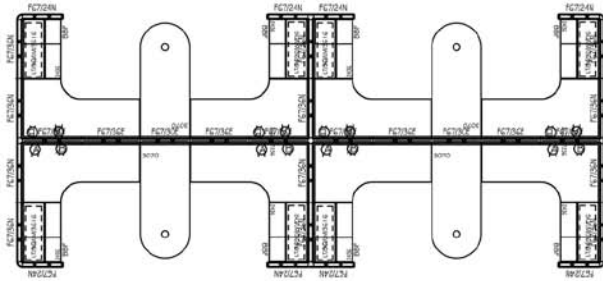

53" High, 6 Stations, 7'x7', Keystone Fabric
 Specs Per Station: BBF, Half Height Shelf, 2 Receptacles
 Worksurfaces: 24" x 42" Straight, 24" x 42" Corner

List Price: \$15,177
 Per Station: \$2,530

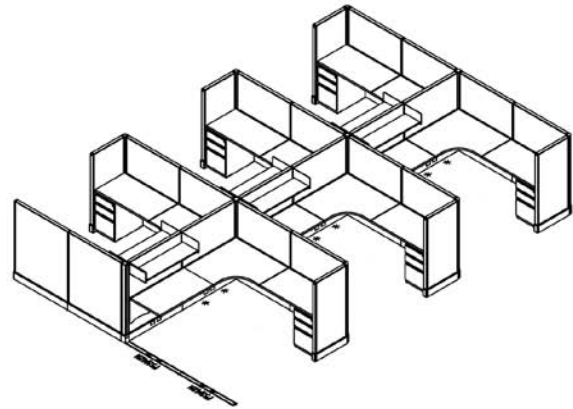
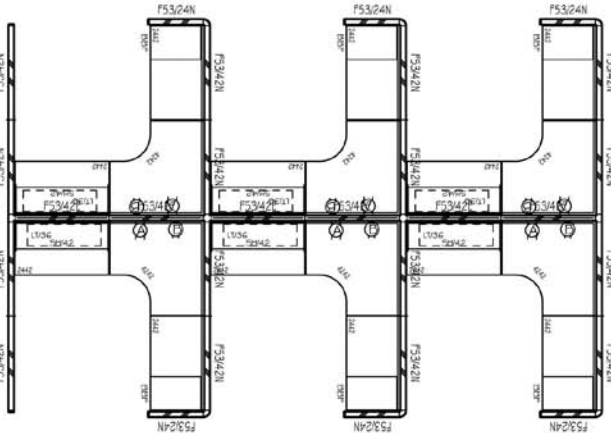

67" High with 53" High Dividers, 6'x6', Keystone Fabric
 Specs Per Station, BBF, FF, Binder Bin, 2 Receptacles
 Worksurfaces: 24" x 36" Straight, 24" x 36" Corner

List Price: \$16,206
 Per Station: \$2,701

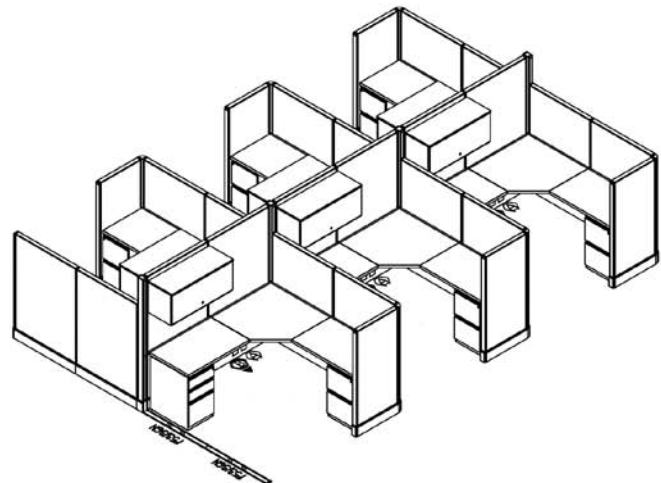
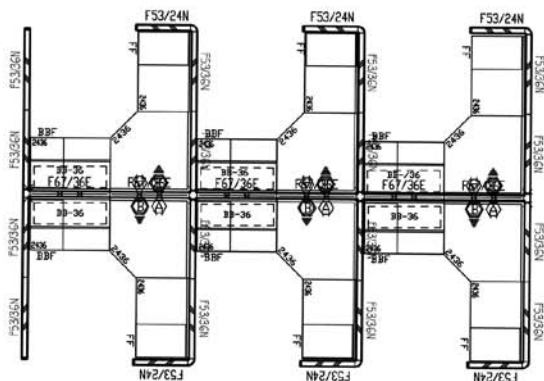

Devon Architectural Elements *Panels with 1/4" Clear Glass Stackers*

- Panel size is finished panel height.
- Orders with glass stackers are not available for Quick Ship.

KEYSTONE SERIES & SUMMIT SERIES PANELS w/ 1/4" Clear Glass Stacker

- Select a fabric from the Keystone or Summit series.

Product Code	Product Description	List Price
HM51.5324	53 X 24 Panel with Glass (39" Panel+14" stacker)	335.00
HM51.5330	53 X 30 Panel with Glass (39" Panel+14" stacker)	385.00
HM51.5336	53 X 36 Panel with Glass (39" Panel+14" stacker)	435.00
HM51.5342	53 X 42 Panel with Glass (39" Panel+14" stacker)	485.00
HM51.5348	53 X 48 Panel with Glass (39" Panel+14" stacker)	515.00
HM51.5360	53 X 60 Panel with Glass (39" Panel+14" stacker)	600.00
HM51.6724	67 X 24 Panel with Glass (53" Panel+14" stacker)	370.00
HM51.6730	67 X 30 Panel with Glass (53" Panel+14" stacker)	420.00
HM51.6736	67 X 36 Panel with Glass (53" Panel+14" stacker)	470.00
HM51.6742	67 X 42 Panel with Glass (53" Panel+14" stacker)	520.00
HM51.6748	67 X 48 Panel with Glass (53" Panel+14" stacker)	565.00
HM51.6760	67 X 60 Panel with Glass (53" Panel+14" stacker)	665.00

ASPEN SERIES PANELS w/ 1/4" Clear Glass Stacker

- Select a fabric from the Aspen Series.

Product Code	Product Description	List Price
HM53.5324	53 X 24 Panel with Glass (39" Panel+14" stacker)	400.00
HM53.5330	53 X 30 Panel with Glass (39" Panel+14" stacker)	450.00
HM53.5336	53 X 36 Panel with Glass (39" Panel+14" stacker)	510.00
HM53.5342	53 X 42 Panel with Glass (39" Panel+14" stacker)	575.00
HM53.5348	53 X 48 Panel with Glass (39" Panel+14" stacker)	630.00
HM53.5360	53 X 60 Panel with Glass (39" Panel+14" stacker)	745.00
HM53.6724	67 X 24 Panel with Glass (53" Panel+14" stacker)	415.00
HM53.6730	67 X 30 Panel with Glass (53" Panel+14" stacker)	475.00
HM53.6736	67 X 36 Panel with Glass (53" Panel+14" stacker)	530.00
HM53.6742	67 X 42 Panel with Glass (53" Panel+14" stacker)	600.00
HM53.6748	67 X 48 Panel with Glass (53" Panel+14" stacker)	660.00
HM53.6760	67 X 60 Panel with Glass (53" Panel+14" stacker)	780.00

* Double glass stacker option is available. Contact customer service for pricing.

Devon Architectural Elements *Panels with 14" Fabric Covered Stackers*

- Panel size is finished panel height.
- An additional top cap is installed between the base panel and stacker.
- Orders with fabric covered stackers are not available for Quick Ship.

KEYSTONE SERIES & SUMMIT SERIES PANELS w/ 14" Fabric Covered Stacker

- Base panel fabric options: Keystone or Summit Series.
- Stacker panel fabric options: Keystone, Summit, or Aspen Series.

Product Code	Product Description	List Price
HM61.5324	53 X 24 Panel with Fabric Stacker (39" Panel+14" stacker)	335.00
HM61.5330	53 X 30 Panel with Fabric Stacker (39" Panel+14" stacker)	385.00
HM61.5336	53 X 36 Panel with Fabric Stacker (39" Panel+14" stacker)	435.00
HM61.5342	53 X 42 Panel with Fabric Stacker (39" Panel+14" stacker)	485.00
HM61.5348	53 X 48 Panel with Fabric Stacker (39" Panel+14" stacker)	515.00
HM61.5360	53 X 60 Panel with Fabric Stacker (39" Panel+14" stacker)	600.00
HM61.6724	67 X 24 Panel with Fabric Stacker (53" Panel+14" stacker)	370.00
HM61.6730	67 X 30 Panel with Fabric Stacker (53" Panel+14" stacker)	420.00
HM61.6736	67 X 36 Panel with Fabric Stacker (53" Panel+14" stacker)	470.00
HM61.6742	67 X 42 Panel with Fabric Stacker (53" Panel+14" stacker)	520.00
HM61.6748	67 X 48 Panel with Fabric Stacker (53" Panel+14" stacker)	565.00
HM61.6760	67 X 60 Panel with Fabric Stacker (53" Panel+14" stacker)	665.00

ASPEN SERIES PANELS w/ 14" Fabric Covered Stacker

- Base panel fabric options: Aspen Series.
- Stacker panel fabric options: Keystone, Summit, or Aspen Series.

Product Code	Product Description	List Price
HM63.5324	53 X 24 Panel with Fabric Stacker (39" Panel+14" stacker)	400.00
HM63.5330	53 X 30 Panel with Fabric Stacker (39" Panel+14" stacker)	450.00
HM63.5336	53 X 36 Panel with Fabric Stacker (39" Panel+14" stacker)	510.00
HM63.5342	53 X 42 Panel with Fabric Stacker (39" Panel+14" stacker)	575.00
HM63.5348	53 X 48 Panel with Fabric Stacker (39" Panel+14" stacker)	630.00
HM63.5360	53 X 60 Panel with Fabric Stacker (39" Panel+14" stacker)	745.00
HM63.6724	67 X 24 Panel with Fabric Stacker (53" Panel+14" stacker)	415.00
HM63.6730	67 X 30 Panel with Fabric Stacker (53" Panel+14" stacker)	475.00
HM63.6736	67 X 36 Panel with Fabric Stacker (53" Panel+14" stacker)	530.00
HM63.6742	67 X 42 Panel with Fabric Stacker (53" Panel+14" stacker)	600.00
HM63.6748	67 X 48 Panel with Fabric Stacker (53" Panel+14" stacker)	660.00
HM63.6760	67 X 60 Panel with Fabric Stacker (53" Panel+14" stacker)	780.00

* Double fabric covered stacker option is available. Contact customer service for pricing.

Connectors

- Panel-to-panel connector ships with top and bottom block assembled.
- 2 and 3-way connectors ship assembled with 5" stem and raceway cover.
- Finished end ships with the raceway cover unassembled.
- Wall-start ships unassembled and can be used to connect panel to a structural wall.

<i>Product Code</i>	<i>Product Description</i>	<i>List Price</i>
HMP213.34	39" Panel-to-Panel Connector	11.00
HMA130.39	39" 2-Way Connector	67.00
HMA137.39	39" 3-Way Connector	77.00
HMC132.34	39" 4-Way Connector	79.00
HMA128.39	39" Finished End Kit	30.00
HMA199.34	39" Wall Start Kit	24.00
HMP213.48	53" Panel-to-Panel Connector	12.00
HMA130.53	53" 2-Way Connector	79.00
HMA137.53	53" 3-Way Connector	97.00
HMC132.48	53" 4-Way Connector	100.00
HMA128.53	53" Finished End Kit	36.00
HMA199.48	53" Wall Start Kit	33.00
HMP213.62	67" Panel-to-Panel Connector	12.00
HMA130.67	67" 2-Way Connector	86.00
HMA137.67	67" 3-Way Connector	115.00
HMC132.62	67" 4-Way Connector	134.00
HMA128.67	67" Finished End Kit	40.00
HMA199.62	67" Wall Start Kit	35.00
HMHL3953	Hi-Lo Filler Strip for 39" to 53" (14")	17.00
HMHL3967	Hi-Lo Filler Strip for 39" to 67" (28")	17.00
HMHL5367	Hi-Lo Filler Strip for 53" to 67" (14")	17.00

Storage

- Binder bin kit ships unassmbled and includes a shelf, full height shelf ends with half radius edge, and assembled locking flipper door unit.
- Half height shelf kit ships unassmbled and includes a shelf with half height shelf ends with half radius edge.
- Full height shelf kit ships unassmbled and includes a shelf with full height shelf ends with half radius edge.
- All storage products are MT finish. BBF and FF pedestals are also available in DT finish.
- Pedestals and laterals include a "G" style pull, a 3/4 extension slide on box drawer and full extension slide on file drawer. Pedestals and laterals each include one (1) lock.

Product Code	Product Description	List Price
HMU271.24	24" Binder Bin Kit w/ Lock	178.00
HMU271.30	30" Binder Bin Kit w/ Lock	218.00
HMU271.36	36" Binder Bin Kit w/ Lock	225.00
HMU271.42	42" Binder Bin Kit w/ Lock	250.00
HMU271.48	48" Binder Bin Kit w/ Lock	269.00
HMU271.60	60" Binder Bin Kit w/ Lock	310.00
HMA281.24	24" Half Height Shelf Kit	89.00
HMA281.30	30" Half Height Shelf Kit	95.00
HMA281.36	36" Half Height Shelf Kit	102.00
HMA281.42	42" Half Height Shelf Kit	109.00
HMA281.48	48" Half Height Shelf Kit	115.00
HMA281.60	60" Half Height Shelf Kit	128.00
HMA282.24	24" Full Height Shelf Kit	89.00
HMA282.30	30" Full Height Shelf Kit	105.00
HMA282.36	36" Full Height Shelf Kit	115.00
HMA282.42	42" Full Height Shelf Kit	121.00
HMA282.48	48" Full Height Shelf Kit	123.00
HMA282.60	60" Full Height Shelf Kit	129.00
BBF-MT	BBF w/ Lock	285.00
FF-MT	FF w/ Lock	285.00
LATFIL-MT	30" 2 Drawer Lateral File w/ Lock	560.00

Worksurfaces

- *Worksurfaces are fabricated from a 1" thick particle board and are laminated on both sides in a thermally fused melamine finish.*
- *Worksurface edges are finished on all sides with a color matched 2mm PVC edge banding.*
- *Custom size worksurfaces are available by request and may require extended lead times.*

Worksurface Program 1: Gray, and Cream

<i>Product Code</i>	<i>Product Description</i>	<i>List Price</i>
WS 2424	24 x 24 Straight Worksurface	57.00
WS 2430	24 x 30 Straight Worksurface	60.00
WS 2436	24 x 36 Straight Worksurface	80.00
WS 2448	24 x 48 Straight Worksurface	107.00
WS 2460	24 x 60 Straight Worksurface	127.00
WS 2472	24 x 72 Straight Worksurface	160.00
WSC 2436	24 x 36 x 36 x 24 Angled Corner Worksurface	120.00
ACC-GR	Grommet and Hole Cut (each)	33.00
MIS-002	Custom cut up-charge (cut existing worksurface size to custom size)	67.00

Worksurface Program 2: Maple and Pepperdust

<i>Product Code</i>	<i>Product Description</i>	<i>List Price</i>
WS 2424	24 x 24 Straight Worksurface	57.00
WS 2430	24 x 30 Straight Worksurface	60.00
WS 2436	24 x 36 Straight Worksurface	80.00
WS 2442	24 x 42 Straight Worksurface	97.00
WS 2448	24 x 48 Straight Worksurface	107.00
WS 2460	24 x 60 Straight Worksurface	127.00
WS 2472	24 x 72 Straight Worksurface	160.00
WSC 2436	24 x 36 x 36 x 24 Angled Corner Worksurface	120.00
WSCR 2442	24 x 42 x 42 x 24 Radius Corner Worksurface	167.00
WSCR 2448	24 x 48 x 48 x 24 Radius Corner Worksurface	194.00
WSECR 243672	24 x 36 x 72 Extended Corner w/ Radius Worksurface	264.00
WSD 3070	30 x 70 D-Top Peninsula w/ 3" BlackMetal Post Leg	297.00
ACC-GR	Grommet and Hole Cut (each)	33.00
MIS-002	Custom cut up-charge (cut existing worksurface size to custom size)	67.00

Support

<i>Product Code</i>	<i>Product Description</i>	<i>List Price</i>
HMP165.16	16" Cantilever (pair)	27.00
HMP166.16	16" Shared Cantilever (each)	17.00
HMP455.01	Corner Bracket (each)	4.00
HMP444.05	Center Transaction Bracket (specify at panel-to-panel connector)	18.00
HMP444.06	End Transaction Bracket (specify at finished end)	18.00
HMP444.07	Mid-End Transaction Bracket (specify at 2, 3, or 4-way)	18.00

Electric

- Electric system is an 8-wire 4-circuit system and is UL listed.
- Double blocks and pass-thrus are shipped loose and are to be field installed to clips. Clips ship pre-assembled to panels.

<i>Product Code</i>	<i>Product Description</i>	<i>List Price</i>
BE-24DB	24" Double Block	111.00
BE-30DB	30" Double Block	136.00
BE-36DB	36" Double Block	149.00
BE-42DB	42" Double Block	155.00
BE-48DB	48" Double Block	161.00
BE-60DB	60" Double Block	174.00
BE-24JU	24" Pass Thru	77.00
BE-30JU	30" Pass Thru	82.00
BE-36JU	36" Pass Thru	87.00
BE-42JU	42" Pass Thru	92.00
BE-48JU	48" Pass Thru	102.00
BE-60JU	60" Pass Thru	114.00
BE-REC1	Receptacle - Circuit 1	17.00
BE-REC2	Receptacle - Circuit 2	17.00
BE-REC3	Receptacle - Circuit 3	17.00
BE-REC4	Receptacle - Circuit 4 (dedicated)	17.00
BE-SDFD	Base Feed (72") (connects in-line with double block)	166.00
BE-SDFD1	Side Feed (72") (connects to duplex location in double block)	184.00
BE-CELFDF	Ceiling Feed (144")	154.00
BE-PP12	Power Pole Kit (144") (includes top and bottom ring)	181.00
BE-NYCFD	NYC Feed (72")	212.00
HP-KP	Hole Punch for Raceway Cover (specify for each receptacle)	3.00

Accessories

<i>Product Code</i>	<i>Product Description</i>	<i>List Price</i>
TB36	36" Tackboard (includes brackets and screws-unassembled)	104.00
TB42	42" Tackboard (includes brackets and screws-unassembled)	110.00
TB48	48" Tackboard (includes brackets and screws-unassembled)	117.00
TB60	60" Tackboard (includes brackets and screws-unassembled)	134.00
TL24	24" Tasklight (20" long) (mounts under shelf)	112.00
TL30	30" Tasklight (26" long) (mounts under shelf)	124.00
TL36	36" Tasklight (32" long) (mounts under shelf)	135.00
TL42	42" Tasklight (38" long) (mounts under shelf)	141.00
ACC-100BK	2" Post Leg (black) (each)	34.00
ACC-101BK	3" Post Leg (black) (each)	60.00
ACC-102BK	4" Post Leg (black) (each)	107.00
HMP720.60	60" Wall Track	37.00
ACC-KT1	Articulating Keyboard Tray (black)	263.00
ACC-CD1	Center Drawer (black) (plastic)	50.00
HDKT	Hardware Kit	6.00



Sales & Customer Service:

Phone: 888-423-0017

Fax: 610-650-9960

Email: sales@devonofficefurniture.com

Headquarters:

1045 S. Trooper Road

Norristown, PA 19403

National Distribution Center:

104 Zoar Road

Chesterfield, SC 29709

Regional Distribution Centers:

Dallas, TX Metro Area

3131 Commonwealth Drive

Dallas, TX 75247

Philadelphia, PA Metro Area

1045 S. Trooper Road

Norristown, PA 19403

Baltimore, MD Metro Area

821 Oregon Avenue

Linthicum, MD 21090